

2-8-0 FREIGHT LOCOMOTIVE AND TENDER 2-RAIL

No. 2225 ORIGINAL TYPE WITH $\frac{1}{4}$ " MOTOR AND No. 2224 MODIFIED TYPE WITH $\frac{1}{8}$ " MOTOR

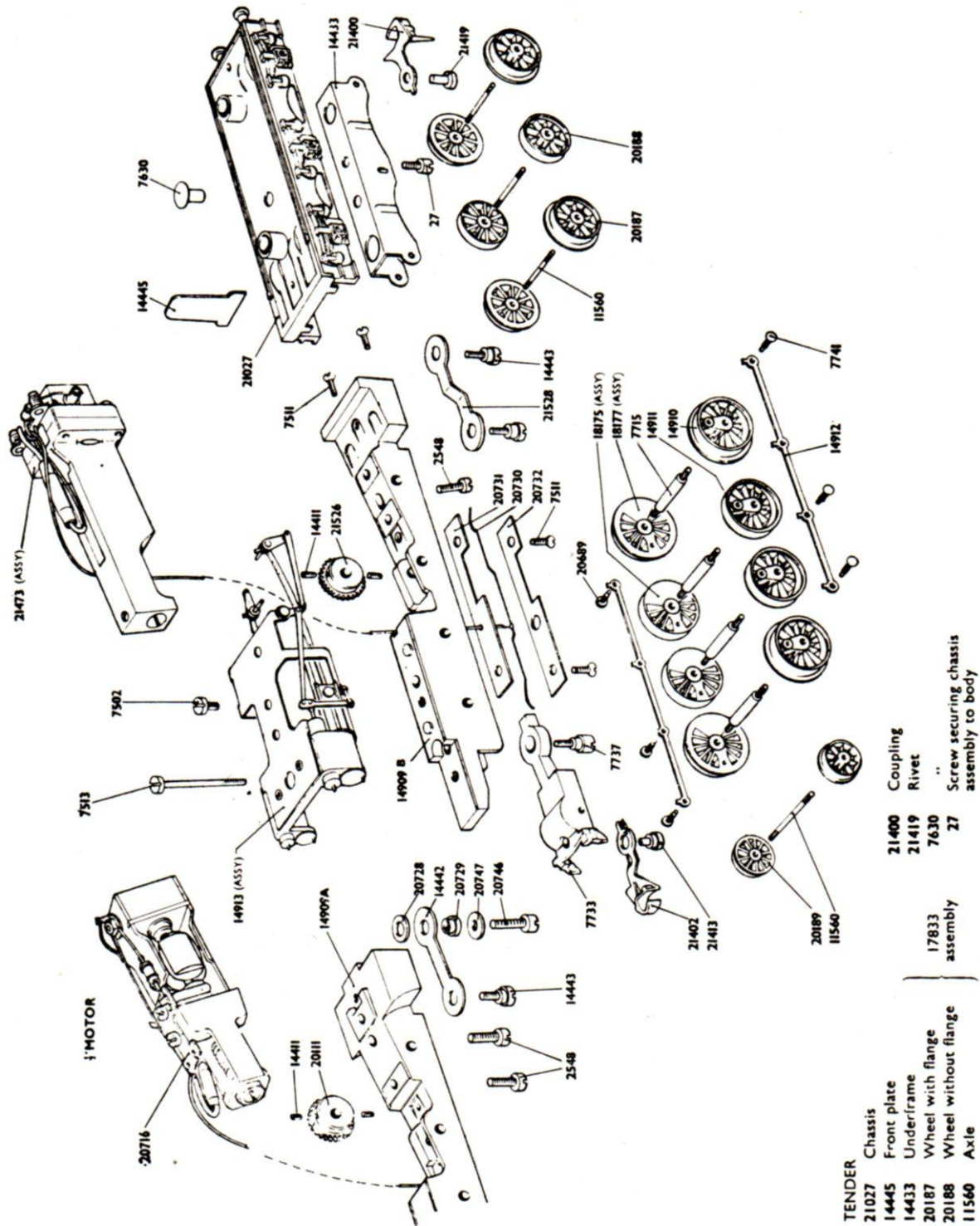

LOCOMOTIVE		TENDER	
14909B	Chassis	21027	Chassis
21473	Motor assembly ($\frac{1}{8}$ " type)	14445	Front plate
21526	Worm wheel	14433	Underframe
7511	Screw securing housing to chassis (rear end)	20187	Wheel with flange
21528	Drawbar	20188	Wheel without flange
14411	Grub screw	11560	Axle
7513	Screw securing housing to chassis (front end)		
25-48	Screw securing motor to chassis		
7502	" cylinder assy. to chassis		
14913	Cylinder assembly		
20730	Wire collector		
20731	Base for collector		
20732	Cover for collector		
7511	Screw for collector		
7733	Front bogie frame		
11560	" axle		
20189	" wheels		
21402	" coupling		
21413	" rivet		
7737	Screw securing front bogie to chassis		
7715	Axle		
18177	Wheel with flange insulated		
18175	Wheel without flange insulated		
14910	Wheel with flange		
14911	Wheel without flange		
14912	Coupling rod		
20689	" pin (insulated wheels)		
7741	" "		
14443	Screw securing drawbar to chassis		
20716	Motor assembly ($\frac{1}{8}$ " type)		
14909	Chassis (obsolete)		
20111	Worm wheel		
14442	Drawbar		
20729	Insulating bush		
20747	Reinforcing washer		
20746	Screw securing drawbar to tender		
20728	Washer		