

**2-8-0 FREIGHT LOCOMOTIVE AND TENDER 3-RAIL**  
No. 3225 ORIGINAL TYPE WITH  $\frac{1}{4}$ " MOTOR AND No. 3224 MODIFIED TYPE WITH  $\frac{1}{4}$ " MOTOR

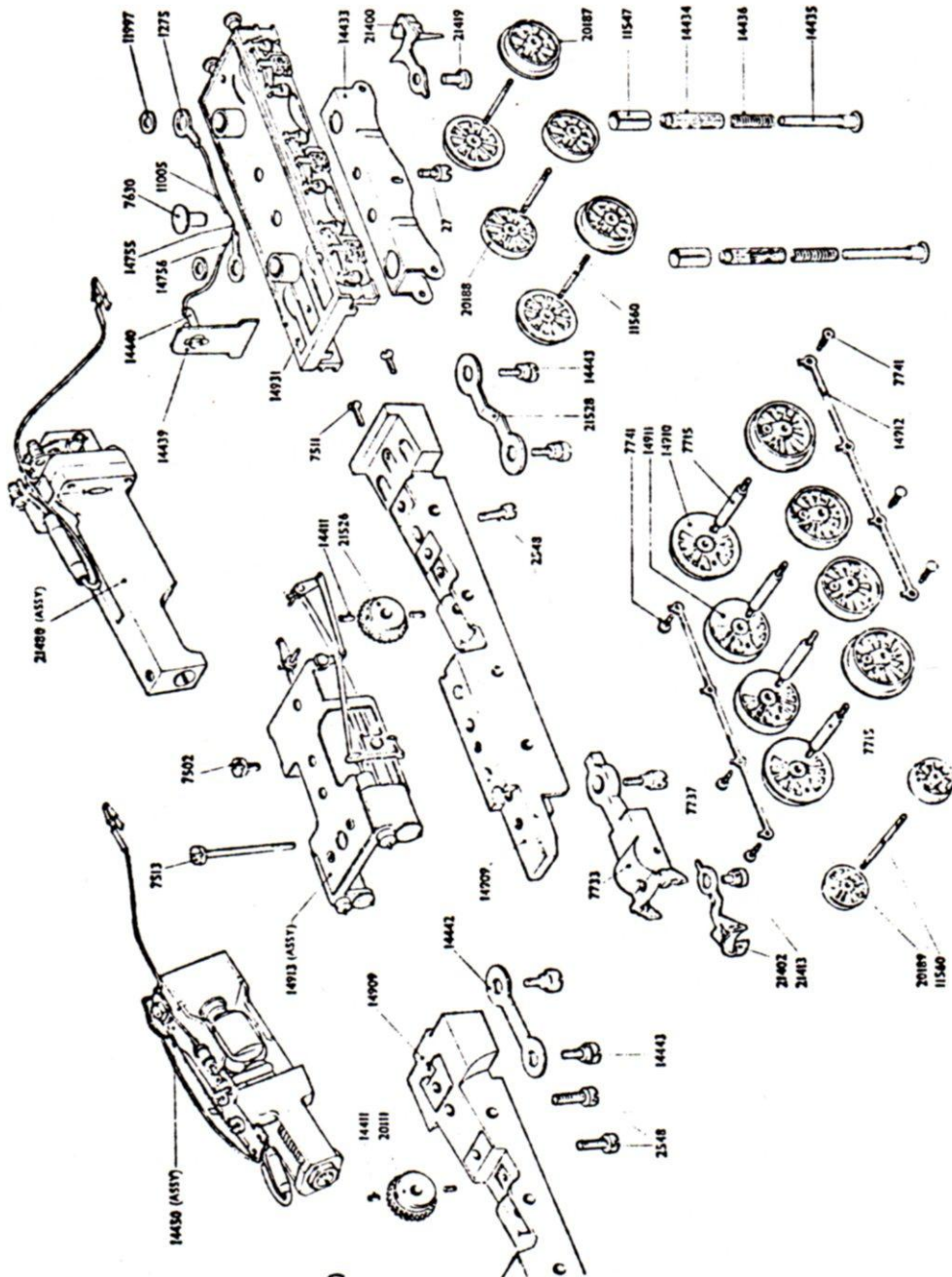

- |                   |  |  |   |   |  |  |                 |                 |                 |                                   |  |  |  |  |  |  |  |  |  |  |  |  |
|-------------------|--|--|---|---|--|--|-----------------|-----------------|-----------------|-----------------------------------|--|--|--|--|--|--|--|--|--|--|--|--|
| <b>LOCOMOTIVE</b> | 14909 Chassis                                | 14913 (ASTY) Screw securing chassis to housing (front end) | 7513 Screw securing chassis to housing (rear end) | 2548 Screw securing motor assembly to chassis | 7502 Screw securing cylinder assembly to chassis           | 14913 (ASTY) Front pony truck frame                  | 7733 axle       | 11560 wheels    | 20189 coupling  | 21402 rivet                       | 7737 Screw securing front pony truck to chassis            | 7715 Axle  | 14910 Wheel with flange                                    | 14911 Wheel without flange                                 | 14912 Coupling rod   | 7741 pin   | 14443 Screw securing drawbar to loco chassis               | 14909 Chassis (for $\frac{1}{4}$ " motor)                  | 20111 Motor assembly $\frac{1}{4}$ "                       | 14432 Worm wheel   | 14432 Drawbar  |  |
|                   | 21400 Motor assembly ( $\frac{1}{4}$ " type) | 21526 Worm wheel   | 7511 Screw securing chassis to housing (rear end) | 14411 (ASTY) Grub screw                       | 14909 (ASTY) Screw securing chassis to housing (front end) | 7511 (ASTY) Screw securing motor assembly to chassis | 7732 (assembly) | 7733 (assembly) | 7715 (assembly) | 20189 (assembly)                  | 14411 (ASTY) Screw securing chassis to housing (front end) | 14909 (ASTY) Screw securing chassis to housing (front end) | 14442 (ASTY) Screw securing chassis to housing (front end) | 14443 (ASTY) Screw securing chassis to housing (front end) | 14443 (ASTY) Screw securing chassis to housing (front end) | 14443 (ASTY) Screw securing chassis to housing (front end) | 14443 (ASTY) Screw securing chassis to housing (front end) | 14443 (ASTY) Screw securing chassis to housing (front end) | 14443 (ASTY) Screw securing chassis to housing (front end) | 14443 (ASTY) Screw securing chassis to housing (front end) | 14443 (ASTY) Screw securing chassis to housing (front end) | 14443 (ASTY) Screw securing chassis to housing (front end) |
|                   | 14931 Chassis                                | 14433 Underframe   | 20187 Wheel with flange                           | 11563 Wheel without flange                    | 14434 Axle   | 14435 Collector shoe holder                          | 11997 Washer    | 14436 Spring    | 11547 Insulator | 27 Screw securing chassis to body | 14443 Screw securing drawbar to tender chassis             | 21400 Coupling   | 21417 Rivet (coupling)                                     | 14756 Connecting wire                                      | 1275 Soldering tag   | 7633 Rivet   | 14437 Insulator  | 14755 Connecting wire                                      | 14440 Eyelet   | 11005 P.V.C. sleeve  |  |  |
| <b>TENDER</b>     | 14931 Chassis                                | 14433 Underframe   | 20187 Wheel with flange                           | 11563 Wheel without flange                    | 14434 Axle   | 14435 Collector shoe holder                          | 11997 Washer    | 14436 Spring    | 11547 Insulator | 27 Screw securing chassis to body | 14443 Screw securing drawbar to tender chassis             | 21400 Coupling   | 21417 Rivet (coupling)                                     | 14756 Connecting wire                                      | 1275 Soldering tag   | 7633 Rivet   | 14437 Insulator  | 14755 Connecting wire                                      | 14440 Eyelet   | 11005 P.V.C. sleeve  |  |  |