

BO-BO DIESEL ELECTRIC LOCOMOTIVE 2-RAIL & 3-RAIL

No. 2230 2-RAIL No. 3230 3-RAIL

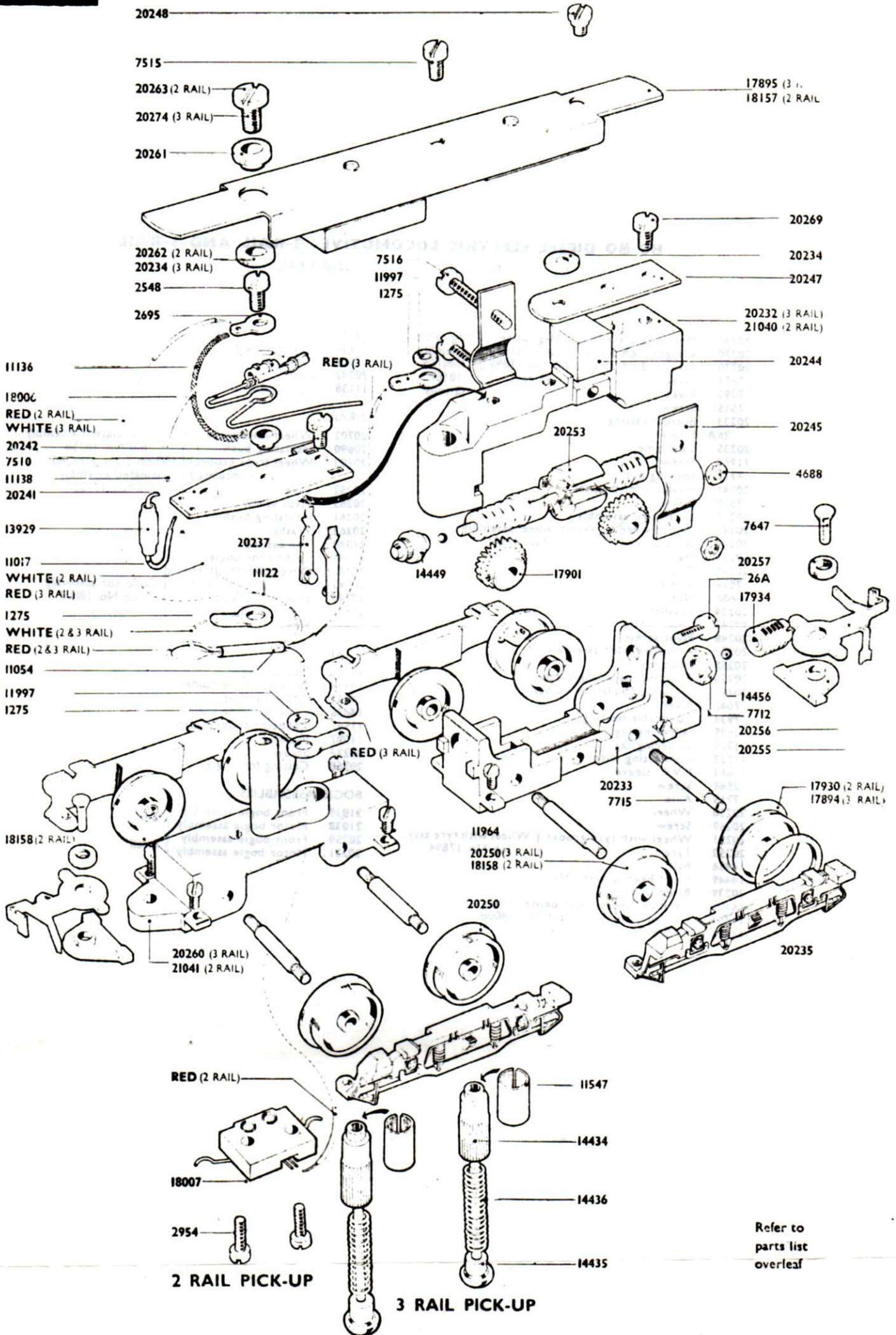

Refer to
parts list
overleaf

BO-BO DIESEL ELECTRIC LOCOMOTIVE 2-RAIL AND 3-RAIL

No. 2230 2-RAIL—No. 3230 3-RAIL

20230	Mounting plate	} Mtg. plate assembly Job No. 17895 (3-rail)	} Mtg. plate assembly Job No. 18157 (2-rail)	13929	Choke
20270	Weight 1 off 3 rail			11136	Copper braid
20270	Weight 3 off 2 rail			11017	P.V.C. sleeve
7621	Rivet			20242	Bush
7093	Rivet			11138	Connecting wire
7515	Screw				
20233	Bottom casting				
26A	Screw			2-RAIL	
20235	Sid:frame			20702	Wheel (insulated) } Wheel (insulated) assembly
11964	Screw			20690	Insulating bush } Job No. 18158
7712	Locking nut			20703	Wheel (tyre groove) } Wheel (tyre groove)
20241	Insulator for brushes				—insulated } insulated assembly
7510	Screw			20252	Tyre } Job No. 17930
20237	Brush arm assembly			20263	Pivot screw
20243	Worm wheel } Worm wheel assembly			20261	Insulating bush
20249	Grub screw } Job No. 17901			20262	Washer
20244	Magnet			21040	Top casting
20245	Pole piece			21041	Casting for bogie
7516	Screw			20742	Wire collector (L.H.) } Collector assembly
4688	Nut			20743	Wire collector (R.H.) } Job No. 18007
20234	Washer			20744	Base for collectors
20247	Swivel plate			20745	Collector retaining pin }
20248	Pivot screw			2954	Screw
20253	Armature shaft assembly				
20255	Coupling			3-RAIL	
20256	Coupling insulating piece			20232	Top casting
20257	Coupling insulating washer			14434	Collector shoe holder
7647	Rivet			14435	Collector shoe
17934	Adjustable bearing			14436	Collector shoe spring
2695	Soldering tag			11547	Collector shoe insulator
1275	Soldering tag			11997	Washer
11122	Connecting wire			20274	Screw
11054	P.V.C. sleeve			20260	Casting for bogie
2548	Screw				
7715	Axle			BOGIE ASSEMBLIES	
20250	Wheel			21039	Front bogie assembly } 2-rail
20269	Screw			21038	Motor bogie assembly }
20251	Wheel with tyre groove } Wheel with tyre assy.			20259	Front bogie assembly } 3-rail
20252	Tyre } Job No. 17894			20231	Motor bogie assembly }
14456	Ball				
14449	Fixed bearing assembly				
20239	Brush spring				
14609	Cambric sleeve } Condenser assembly				
14481	Copper strip } Job No. 18006				
14482	Condenser				