

All these Models can be built with Meccano Dinky Builder Outfit No. 0

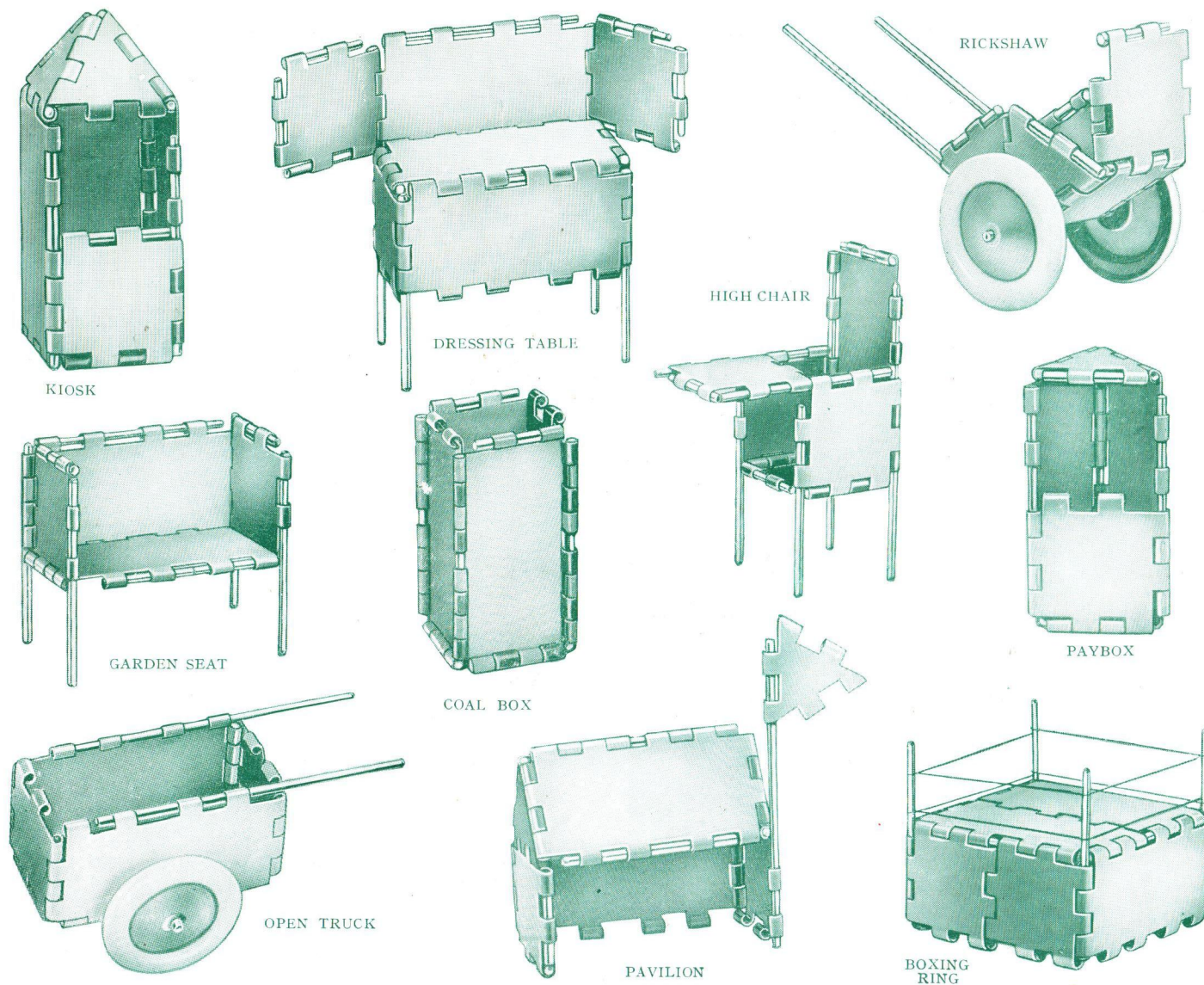

All these Models can be built with Meccano Dinky Builder Outfit No. 0

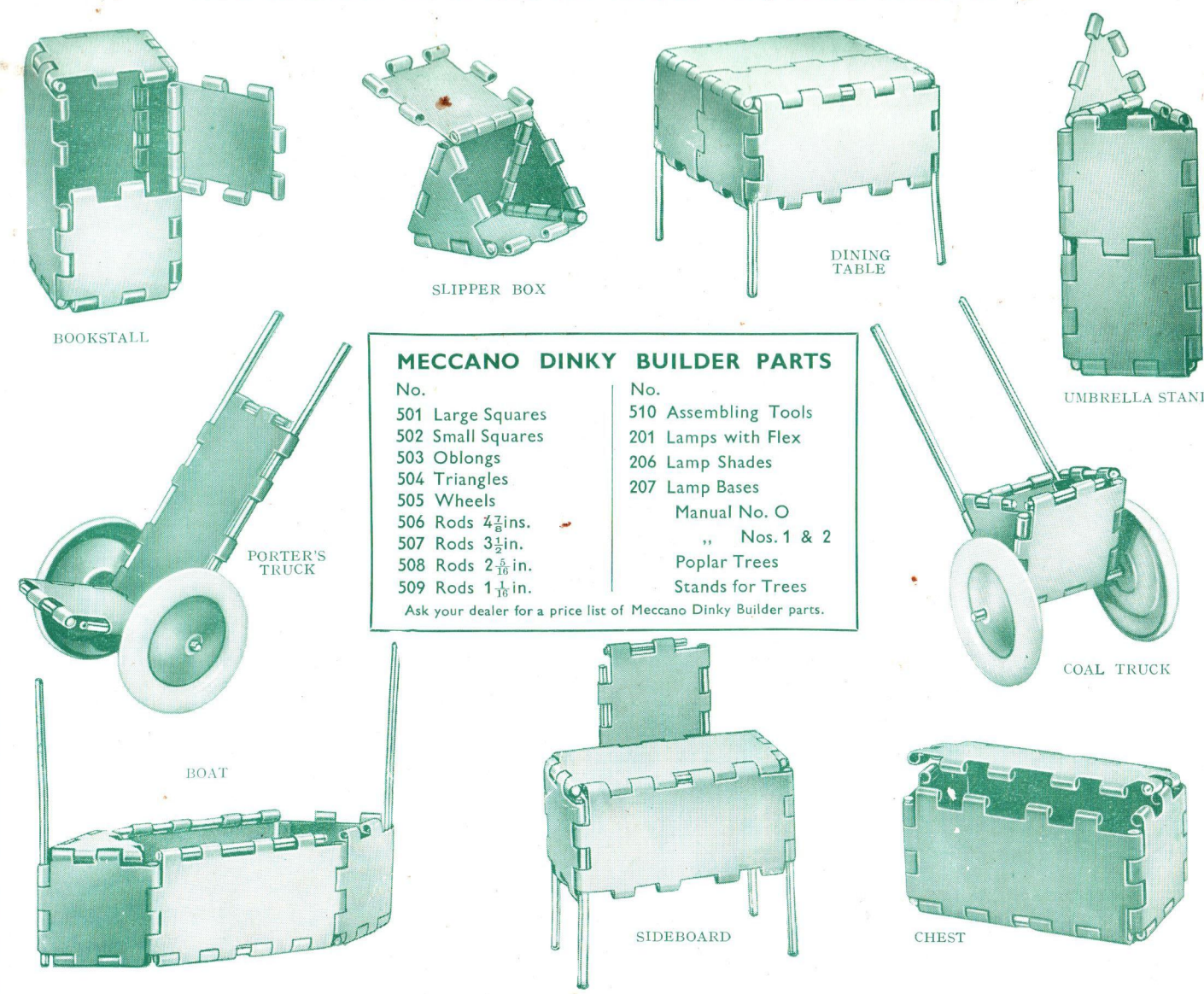

#### MECCANO DINKY BUILDER PARTS

No.	No.
501 Large Squares	510 Assembling Tools
502 Small Squares	201 Lamps with Flex
503 Oblongs	206 Lamp Shades
504 Triangles	207 Lamp Bases
505 Wheels	Manual No. 0
506 Rods $4\frac{7}{8}$ in.	" Nos. 1 & 2
507 Rods $3\frac{1}{2}$ in.	Poplar Trees
508 Rods $2\frac{5}{16}$ in.	Stands for Trees
509 Rods $1\frac{1}{16}$ in.	

Ask your dealer for a price list of Meccano Dinky Builder parts.

# MECCANO

# DINKY BUILDER

## INSTRUCTIONS

FOR

### No. 0 OUTFIT

COPYRIGHT BY  
MECCANO LTD. - BINNS ROAD - LIVERPOOL 13

35.DBO

13/635/30

PRICE  
Great Britain 2d.  
South Africa 2d.  
Australia 2d.  
New Zealand 2d.  
Canada 2c.



Instructions for Meccano Dinky Builder Outfit No. O

Meccano Dinky Builder Plates are hinged on all sides, with intervening spaces, so that when two are placed side by side the hinged part of one Plate fits into the corresponding space in the other. A Rod can be pushed through the complete hinge, and in this manner any number of Plates can be built up to form various geometrical shapes.

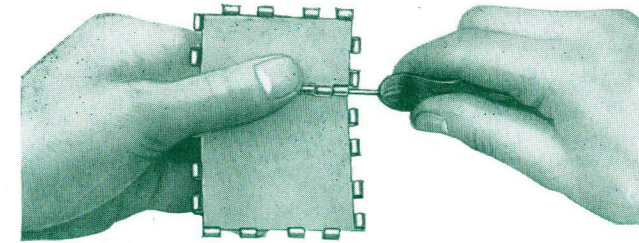

Fig. 1

The simplest method of connecting a series of Plates together to construct a model is first to lay out the necessary parts, hinges upward, on a flat surface, in the positions they will occupy in the completed models. (See Fig. 2). The Rods are then inserted, the special tool supplied with the Outfit being used to push them in. (See Fig. 1).

Where a rod is inserted in the hinges of one plate only, it may occasionally be found that the rod is not gripped quite firmly enough to hold it in position. This may be easily adjusted by inserting the rod in the first hinge of the plate and gently bending this *very slightly* out of line with the other hinges (see Fig. 3). Then, when the rod is once more pushed through all the hinges, it will be held securely.

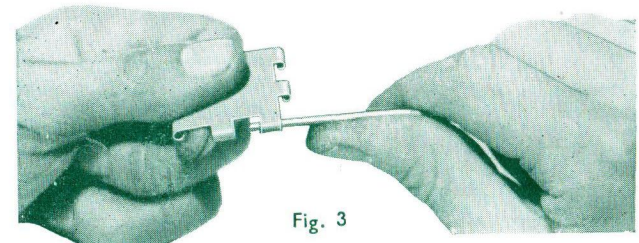

Fig. 3

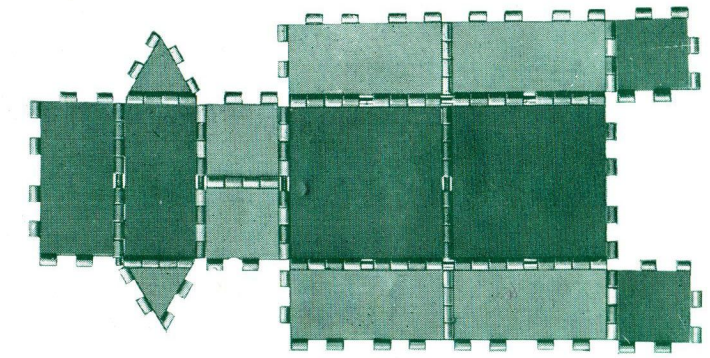
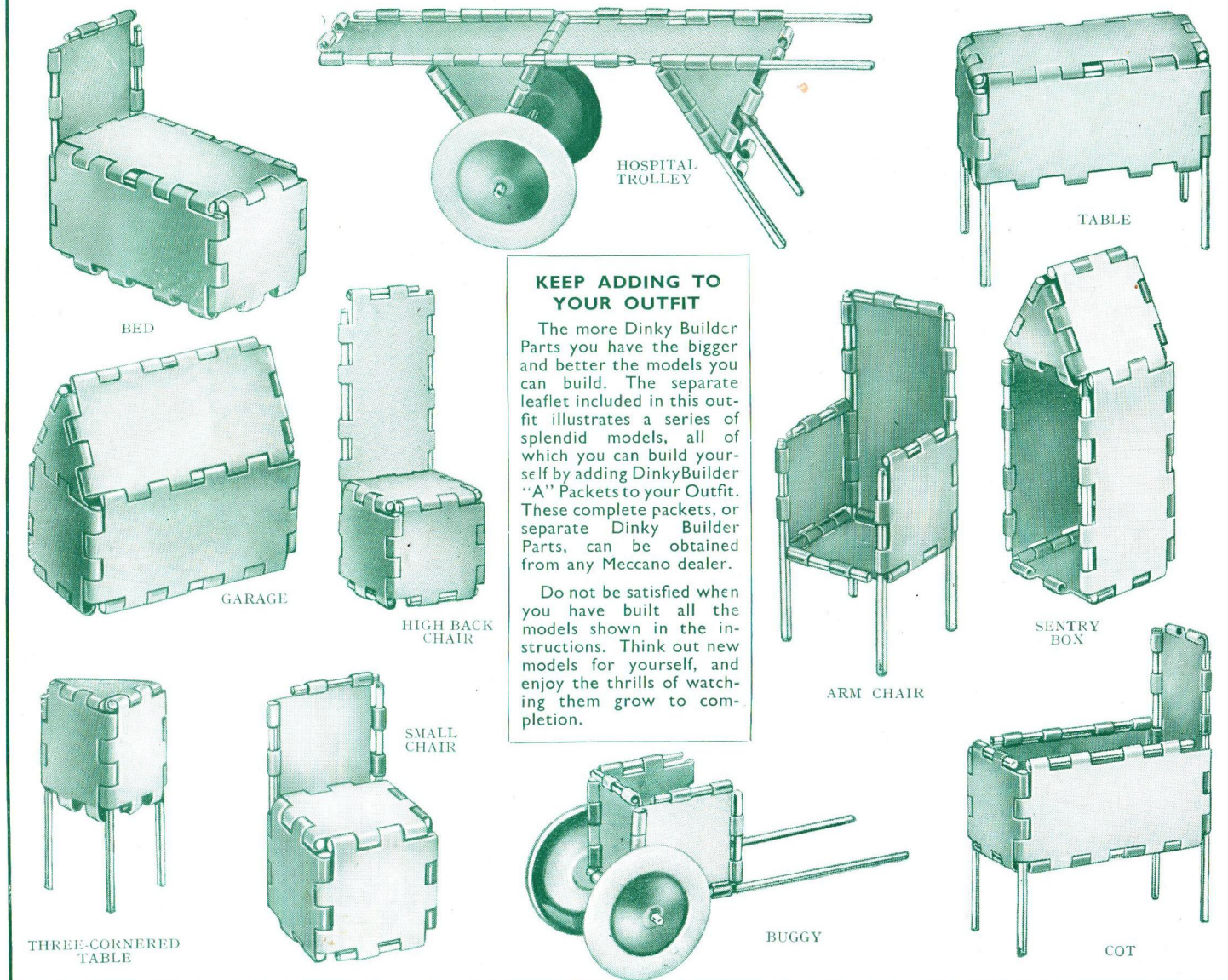

Fig. 2

It is sometimes necessary to bring the hinges of two separate Plates into line before the Rod is inserted. In such cases the task of lining up will be greatly simplified by using the tool in the manner of a "drift." That is to say, it is pushed through the hinges so that they are brought into line, and is then withdrawn.

The tool must be used when disassembling the models. For this purpose it is pushed into the hinge forming the constructional connection, so that the Rod is forced out. In this manner a model can be taken to pieces in a very short time.

All these Models can be built with Meccano Dinky Builder Outfit No. O



KEEP ADDING TO YOUR OUTFIT

The more Dinky Builder Parts you have the bigger and better the models you can build. The separate leaflet included in this outfit illustrates a series of splendid models, all of which you can build yourself by adding Dinky Builder "A" Packets to your Outfit. These complete packets, or separate Dinky Builder Parts, can be obtained from any Meccano dealer.

Do not be satisfied when you have built all the models shown in the instructions. Think out new models for yourself, and enjoy the thrills of watching them grow to completion.