

All these Models can be built with Dinky Builder Outfit No. O

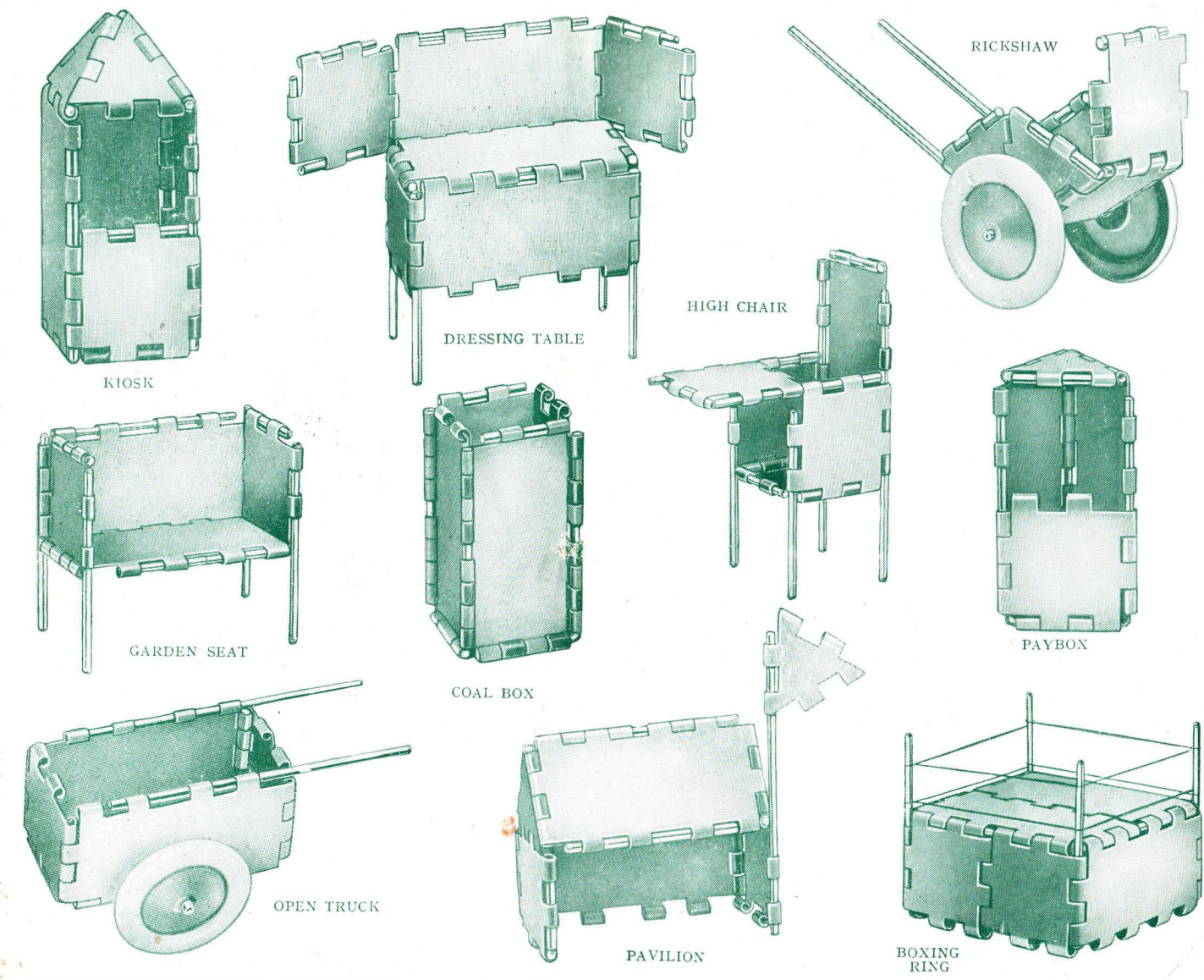

All these Models can be built with Dinky Builder Outfit No. O

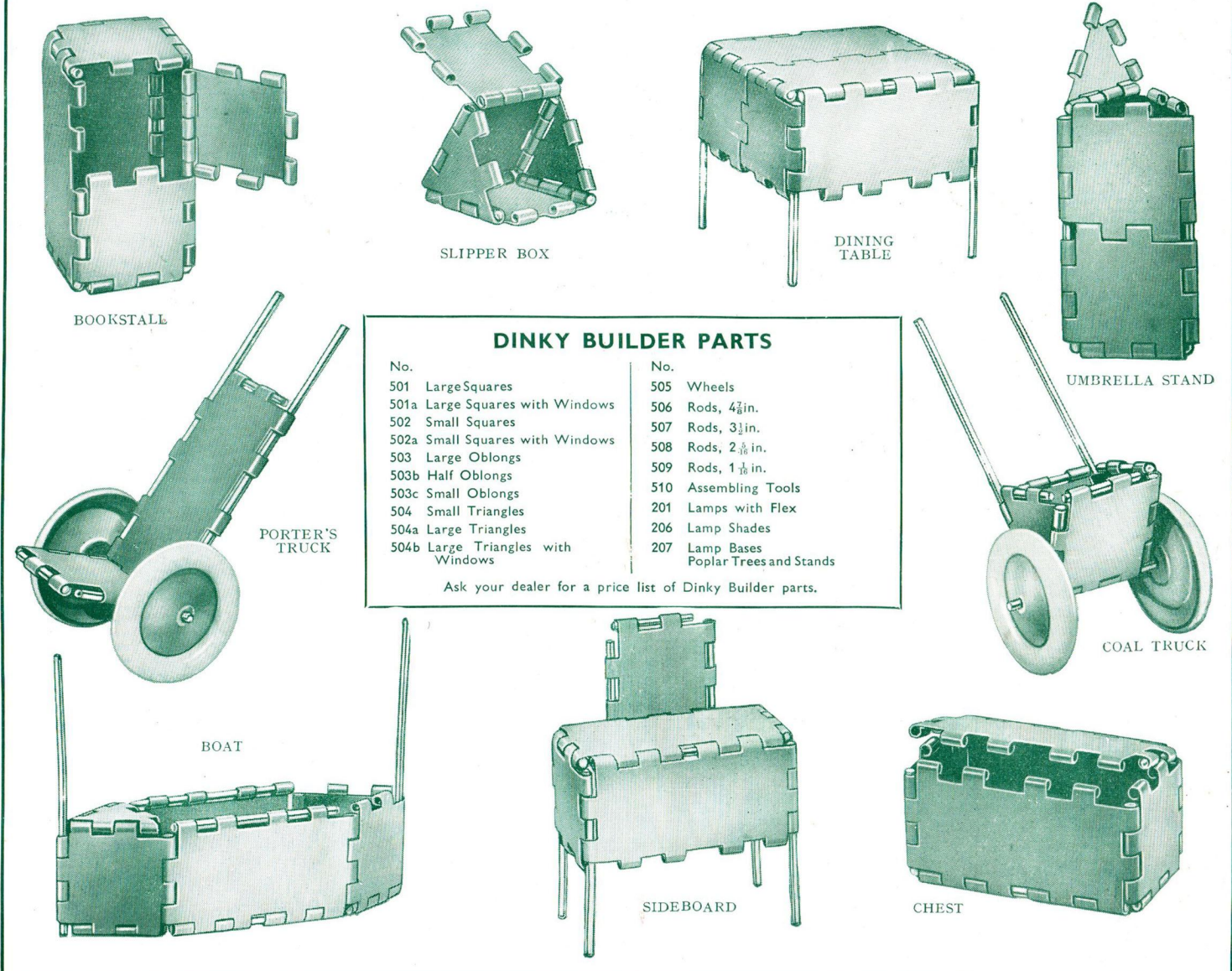

DINKY BUILDER PARTS	
No.	No.
501 Large Squares	505 Wheels
501a Large Squares with Windows	506 Rods, 4 3/4 in.
502 Small Squares	507 Rods, 3 1/2 in.
502a Small Squares with Windows	508 Rods, 2 3/8 in.
503 Large Oblongs	509 Rods, 1 1/8 in.
503b Half Oblongs	510 Assembling Tools
503c Small Oblongs	201 Lamps with Flex
504 Small Triangles	206 Lamp Shades
504a Large Triangles	207 Lamp Bases
504b Large Triangles with Windows	Poplar Trees and Stands
Ask your dealer for a price list of Dinky Builder parts.	



DINKY BUILDER

INSTRUCTIONS

FOR

No. O OUTFIT

COPYRIGHT BY

MECCANO LTD. - BINNS ROAD - LIVERPOOL 13

36.DBO

PRICE

Great Britain 2d.
South Africa 2d.
Australia 2d.
New Zealand 2d.
Canada 2c.

Instructions for Dinky Builder Outfit No. O

Dinky Builder Plates are hinged on all sides, with intervening spaces, so that when two are placed side by side the hinged part of one Plate fits into the corresponding space in the other.

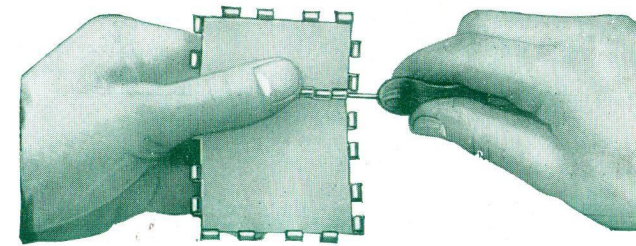

Fig. 1

A Rod can be pushed through the complete hinge, and in this manner any number of Plates can be built up to form various geometrical shapes.

The simplest method of connecting a series of Plates together to construct a model is first to lay out the necessary parts, hinges upward, on a flat surface, in the positions they will occupy in the completed models. (See Fig. 2). The Rods are then inserted, the special tool supplied with the Outfit being used to push them in. (See Fig. 1).

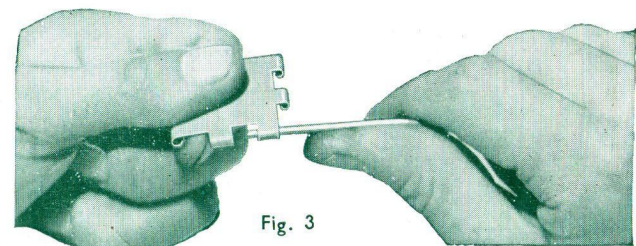

Fig. 3

It is sometimes necessary to bring the hinges of two separate Plates into line before the Rod is inserted. In such cases the task of lining up will be greatly simplified by using the tool in the manner of a "drift." That is to say, it is pushed through the hinges so that they are brought into line, and is then withdrawn.

The tool must be used when disassembling the models. For this purpose it is pushed into the hinge forming the constructional connection, so that the Rod is forced out. In this manner a model can be taken to pieces in a very short time.

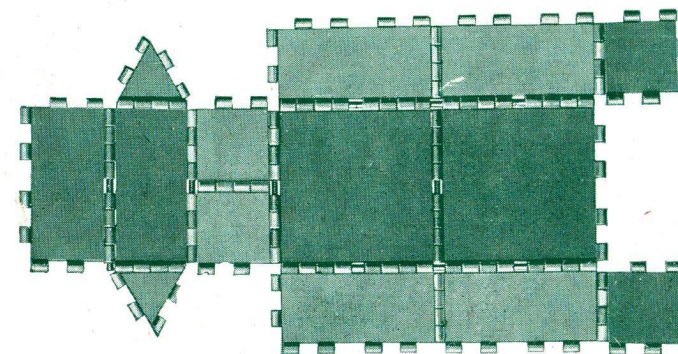
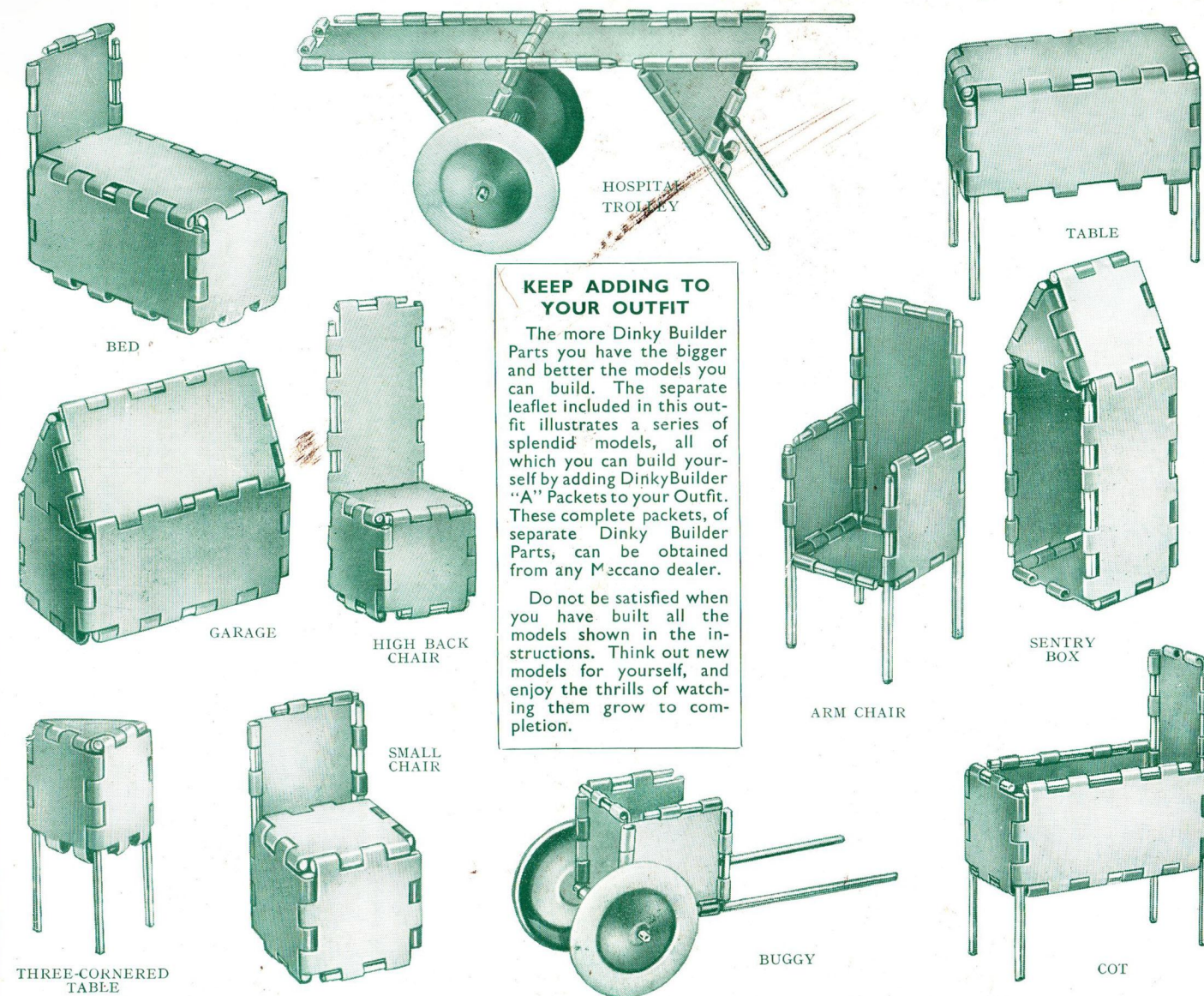

Fig. 2

Where a rod is inserted in the hinges of one plate only, it may occasionally be found that the rod is not gripped quite firmly enough to hold it in position. This may be easily adjusted by inserting the rod in the first hinge of the plate and gently bending this *very slightly* out of line with the other hinges (see Fig. 3). Then, when the rod is once more pushed through all the hinges, it will be held securely.

All these Models can be built with Dinky Builder Outfit No. O



All these Models can be built with Dinky Builder Outfit No. O

