

JUNEERO DESIGN SHEET N°61

HERE ARE SOME
REALISTIC ACC-
ESSORIES YOU
CAN MAKE FOR
YOUR MODEL
RAILWAY.

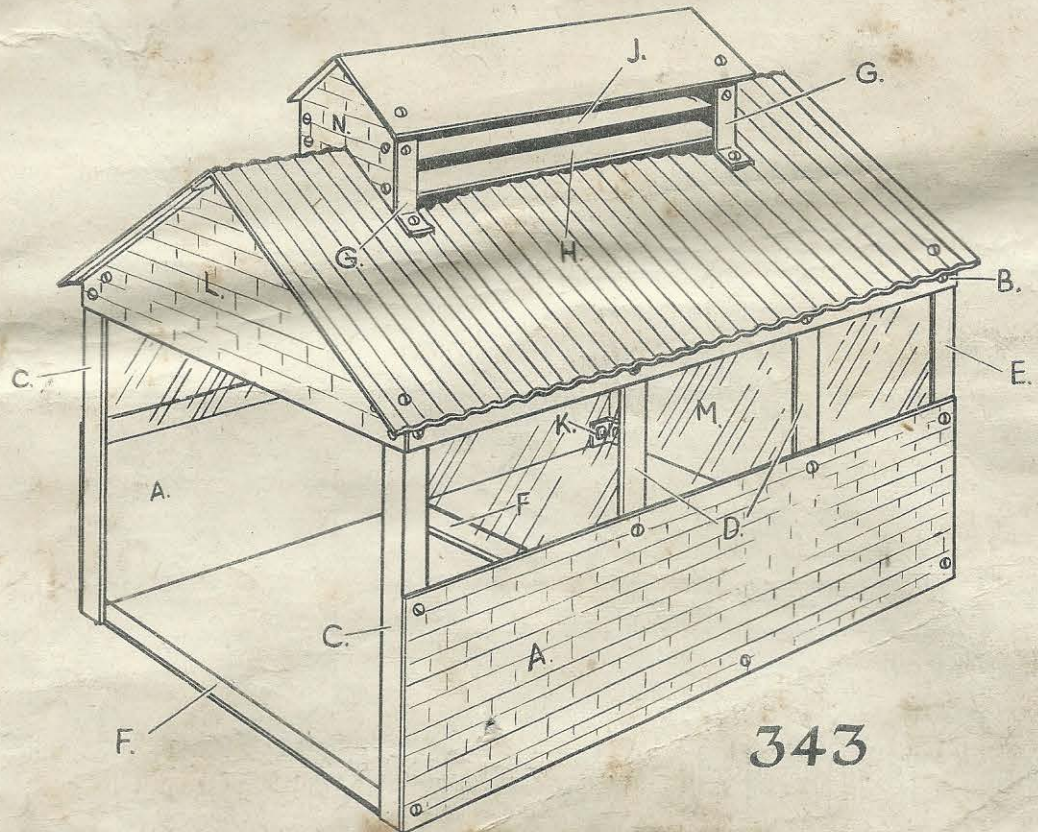

343

ENGINE SHED

SEE OVERLEAF FOR DETAILS OF
CONSTRUCTION. CUT THE SECTIONS
ACCORDING TO MEASUREMENTS GIVEN
AND ASSEMBLE IN THE ORDER A.B.C.

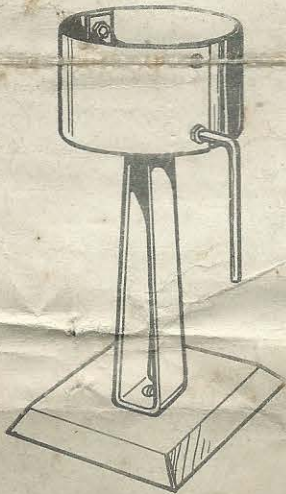

344

WATER TANK

THE TANK AND BASE
ARE MADE FROM RULED
METAL. THE PIPE IS A
SHORT LENGTH OF ROD
THREADED AND HELD WITH
TWO NUTS.

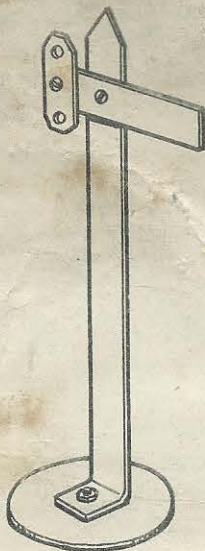

346

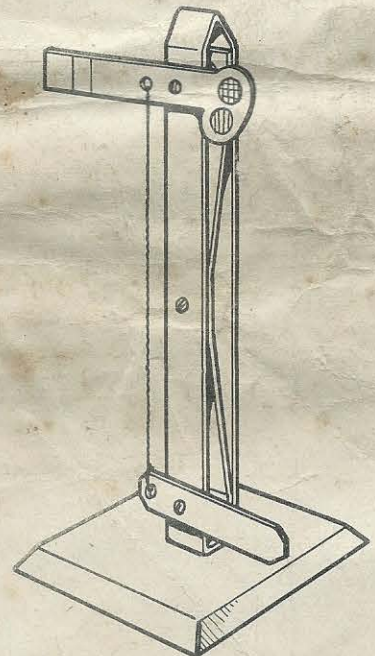

345

SIGNALS

HERE ARE TWO WAYS YOU
CAN MAKE A SIMPLE LITTLE
SIGNAL.

THE ARTICLE "HOW TO READ A JUNEERO BLUE PRINT" IN THE
JUNEERO MANUAL IS VERY HELPFUL TO BEGINNERS.

(A)
CUT 2
OF THIS.

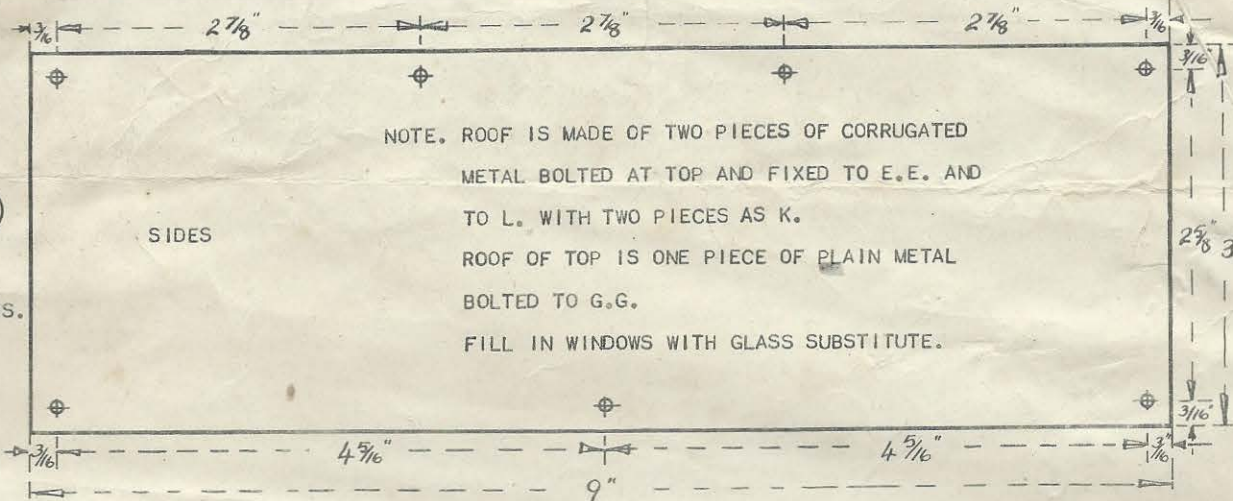

DETAILS OF
2 5/8" 3" CONSTRUCTION
OF NO. 343.

(B)
2 REQUIRED

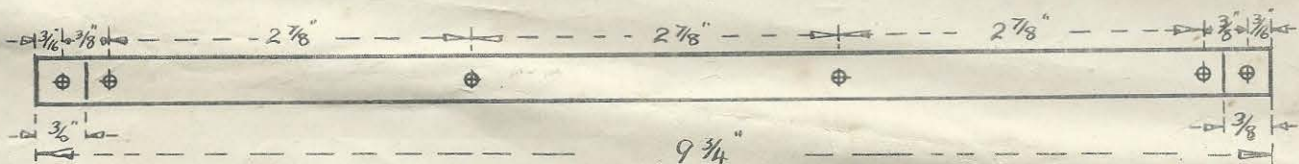

(C)
ANGLE IRON
2 REQUIRED



(E)
2 REQUIRED

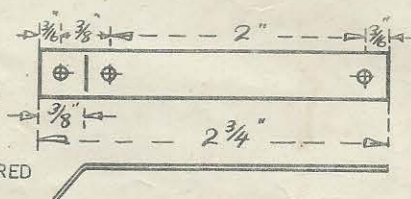

JOIN THE TOPS OF THE FOUR UPRIGHTS D WITH TWO STRIPS AS F.

(D)
4 REQUIRED



BEND G. AS THIS.

(F)
4 REQUIRED

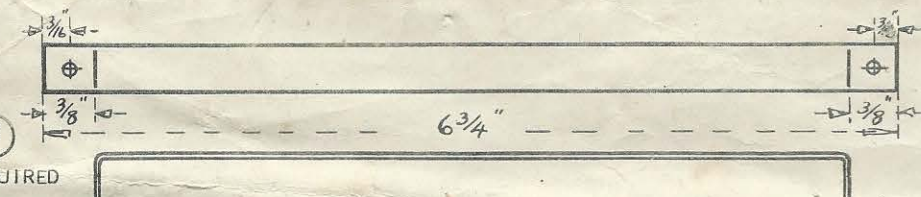

(G)
2 REQUIRED

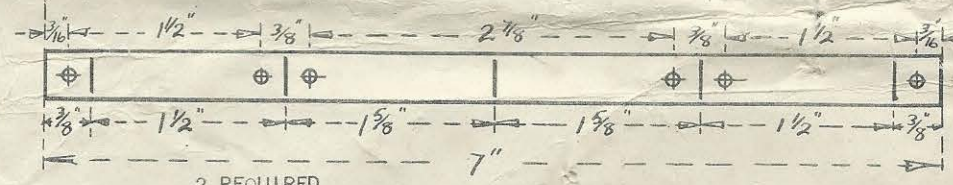

(L)

Note: This hole required for L only

(K)
4 REQUIRED

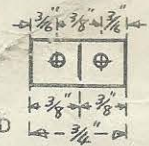

BEND H. & J. SIMILAR TO F.

(N)
2 REQUIRED

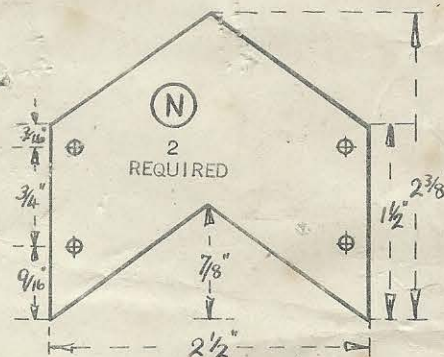

FIX BACK M. AT TOP TO B. AND AT BOTTOM TO A. WITH TWO PIECES AS K.

(M)

5"

(H)
2 REQUIRED



(J)
2 REQUIRED

