

# SKYLINE JOY'S MAIN STREET

*New and Improved*

UNIQUE  
**FOLD A WAY**  
CONSTRUCTION  
FINISHED IN 15  
MINUTES  
EASY TO BUILD  
WITH  
**JOY**



**A COMPLETE MINIATURE VILLAGE**

THE SKYLINE MANUFACTURING CO., INC., PHILADELPHIA, PA.  
MADE IN UNITED STATES OF AMERICA



# SKYLINE MAIN STREET

JOY'S TOYS

New and Improved

UNIQUE  
FOLD-A-WAY  
CONSTRUCTION  
RECOMMENDED SET UP  
IN 2  
JIFFY



**MAIN STREET** is a typical crossroads village in miniature—just what you have always wanted for your train or garden around your Christmas Tree. The Church, Town Hall, Stores, Houses, Trees, Billboards, and Autos fit perfectly with trains of almost any size or gauge. However, when used with the popular gauges it is suggested you place your buildings in the background just a bit away from the tracks. Since the buildings are smaller than your trains this gives an illusion of depth and perspective and makes your layout appear to take in far more space than it actually does.

### INSTRUCTIONS

There are two sheets in the set which have been printed in full color to represent windows. These have been included as an optional feature. It is not absolutely necessary to use them... but they will add a great deal of realism to your village, especially the mechanical details in the store windows. If used, they should be inserted before you begin to set up the buildings. The printing on the sheets will show each window facing. Cut them from this sheet, using

Many parts, including scratch tape in model corners, attach the windows in their respective positions to the inside of the building sections. (optional side). The sides of the buildings have been scored on three corners and the two sides meeting in the fourth corner are joined with a strip of tape included in set. The tape is cut to length as required, folded down the center of its length, reinforced and applied to the open corner as the inside.

Two hints before starting: (1) If tabs do not fit snugly in slots increase slot opening by inserting tip of small screw driver or pencil knife. (2) To give a most realistic appearance a dab of latex may be used on cracks to hold roofs in place. If you make sure he use but as they amount of latex it will be quite easy to disassemble the buildings without harm when putting your set away. Commence with Building No. 1 and follow the illustrations.

### BUILDING No. 1

- STEP A—Cut piece of tape long enough to join the open corner of Building. (Cut from 25¢ tape.)
- STEP B—Crease the tape lengthwise down center so it will fit snugly in corner.
- STEP C—Bend corners of Building along scores to form rectangular structure as shown.
- STEP D—Join open ends. Moisten gummed side of tape cut for this purpose (STEP A) and apply to inside portions of open corner. See arrow D in diagram.
- STEP E—Now cut four more strips of tape—6 1/2", 1" and two pieces 1 1/2" long. Crease in center as before. These are for inside reinforcement. Lower Tower, Middle Tower and Upper Tower respectively.
- STEP F—Bend inside reinforcement and Tower Sections along scores, just as you did with of

Building. Join open ends of each section with the strips of tape you have just cut.

STEP G—Insert inside reinforcement in building.

STEP H—Insert tabs of Lower Tower in slots in front wall of building.

STEP I—Place Capping on Lower Tower. Tabs on top of Tower fit into slots in Capping.

STEP J—Next comes the Middle Tower. Tabs on bottom of this fit in other two slots in capping you have just installed.

STEP K—Install Middle Capping. Upper Tower and Upper Capping by inserting tabs in respective slots.

STEP L—Bend shingle into pyramid shape. Hold in position by inserting tabs in slot. Center on top of completed tower.

STEP M—Bend roof along center score and place on top of building.



BUILDING No. 1 CHURCH

### BUILDING No. 2

- STEP A—Proceed as you did with Building No. 1, cutting tape, proper lengths—in this case two pieces 3 1/2" for open corners of Sections A and B of Building, and one piece 1 1/2" for open corner of Tower.
- STEP B—Crease tape, bend corners of building sections and tower, moisten tape and seal open corners as you did on Building No. 1.
- STEP C—Join side section A to section B at right angles. Slots in bottom of A fit into slots in top of B. Force together gently.
- STEP D—Bend roof of Section A along center score and place in position. Center so

that overhang at each end is uniform.

STEP E—Repeat above step for roof of Section B. Section B roof is notched to straddle Section A roof at right angles. A dab of glue on lower edge of tables may be used to keep roof in position.

STEP F—Install Clock Tower. This is notched to fit over roofs at center of building.

STEP G—Place Capping over tower. Center this so that overhang is uniform on all sides.

STEP H—Bend tower roof to shape. Hold in position by inserting tabs in slots. Center on top of capping.



BUILDING No. 2 TOWN HALL



BUILDING No. 3 TOWER

### BUILDING No. 6



BUILDING No. 6









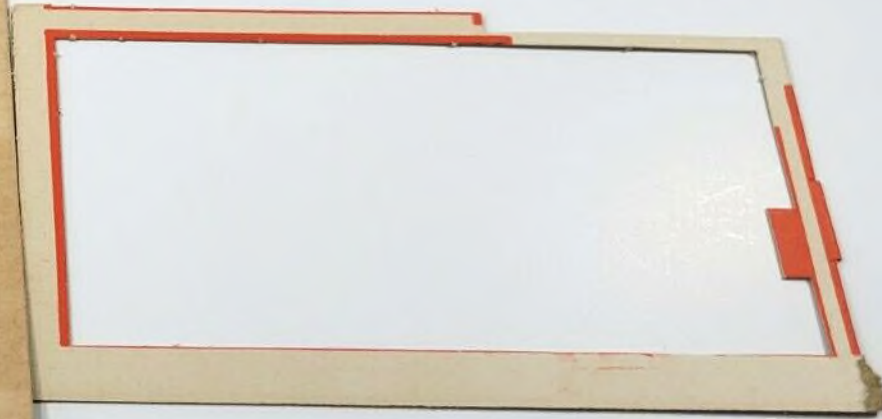
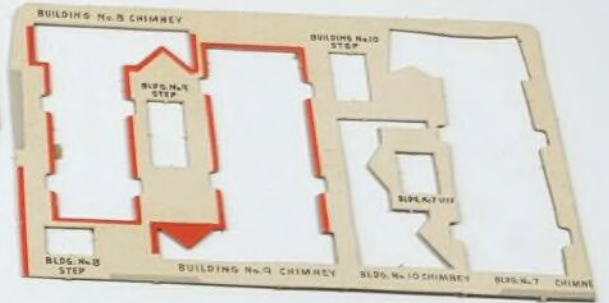







SKYLINE SET No. 220 WINDOWS  
BUILDING No. 9

